

Elevator Bolts

Bolting Sets Options



For buckets with recessed holes use: Bolt, hexagon nut, spring washer, and **domed washer**.



For plastic buckets with flat holes use: Bolt, hexagon nut, spring washer and **large flat washer**.



For steel buckets with flat holes use: Bolt, hexagon nut, spring washer and **small flat washer**.

Fang Bolts

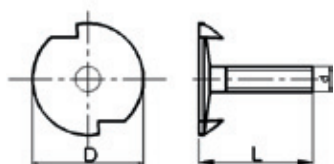

FEATURES

- With 2 fangs on the head for better biting into the belt, to prevent from rotation when tightening.
- Available in Carbon Steel (Galvanized).

SPECIFICATIONS

| Size (Nominal) | Diameter of Head (mm) D | Length (L) | | | | | | |
|----------------|-------------------------|--------------------|---------|---------|---------|---------|---------|---------|
| | | 25 (mm) | 30 (mm) | 35 (mm) | 38 (mm) | 40 (mm) | 45 (mm) | 50 (mm) |
| | | Weight (kg/100pcs) | | | | | | |
| M6 | 23 | 1.07 | 1.22 | | 1.36 | | | |
| M8 | 27 | | 1.85 | 1.97 | | 2.1 | 2.24 | |
| M10 | 33 | | 2.23 | 3.1 | | 3.49 | 3.62 | 3.91 |

Note: Customized length is available on request.

Euro Bolts

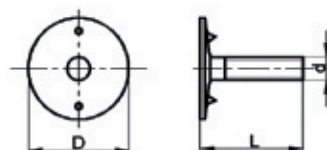

FEATURES

- 2 raised lugs on the bolt head to prevent rotation when tightening.
- Available in Carbon Steel (Galvanized).

SPECIFICATIONS

| Size (Nominal) | Diameter of Head (mm) D | Length (L) | | | | | | | | |
|----------------|-------------------------|--------------------|---------|---------|---------|---------|---------|---------|---------|---------|
| | | 20 (mm) | 25 (mm) | 30 (mm) | 35 (mm) | 40 (mm) | 45 (mm) | 50 (mm) | 60 (mm) | 70 (mm) |
| | | Weight (kg/100pcs) | | | | | | | | |
| M6 | 20 | 0.95 | 1.04 | 1.13 | | | | | | |
| M8 | 28 | | 1.82 | 1.98 | 2.14 | 2.29 | 2.45 | 2.60 | | |
| M10 | 35 | | | 3.40 | 3.64 | 3.89 | 4.14 | 4.38 | | |
| M12 | 40 | | | | 4.73 | 5.09 | 5.45 | 5.80 | 6.52 | 7.23 |

Note: Customized length is available on request.